



GrowControl™ GC-XO

Output Expansion Controller



Hardware & Installation Manual

 **WARNING**

Read these requirements, installation and operating instructions very carefully.
Failure to follow the instructions could result in a controller malfunction.
A malfunction could result in serious equipment damage, property damage, bodily injury or death.

Specifications

Power Input: 24Vdc 1.67-2.7A Class II Only (2.1mm center positive)

Power Outputs: 24Vdc (22 nominal)

Max current per output: 50mA

Important Information

NOTICE

Agrowtek Inc. recommends professional installation by a qualified, licensed electrician. Failure to install this equipment in accordance with these instructions may result in equipment damage and/or voiding the warranty.



DANGER

Electrocution Hazard

Always disconnect all electrical power to the controller and the electrical systems it may be connected to before wiring, service or maintenance. Disconnecting the controller's power supply may not remove power from the controlled circuits.



WARNING

This system operates only on 24Vdc.

NEVER CONNECT AC POWER TO THE CONTROLLER.

All power must be switched with Agrowtek's RX/CX/RD relays only.

NOTICE

Protect the controller and power supply with a properly functioning surge suppressor.

IMPORTANT

DRY LOCATION USE ONLY

This control system, climate sensor, hydroponics transmitter, and other sensors that are not specifically designed for immersion in water, are for use in dry locations only. (0-95% RH non-condensing)

Install controller, sensors, relay boxes and other electrical and electronic equipment where it will not be exposed to water or splashing. Controller may be installed in a water-resistant enclosure; see installation instructions.

NOTICE

Install all electrical equipment and wiring in accordance with national and local electric codes.

GrowControl™ GC-XO

The XO Slave connects to a “master” GC-Pro series controller to expand the outputs when the expansion slots in the master controller have been exhausted. The XO controller is outputs-only and takes no sensor inputs. All commands for operating the outputs come from the master controller via the Ethernet port. A properly configured router is required to operate the XO controller.

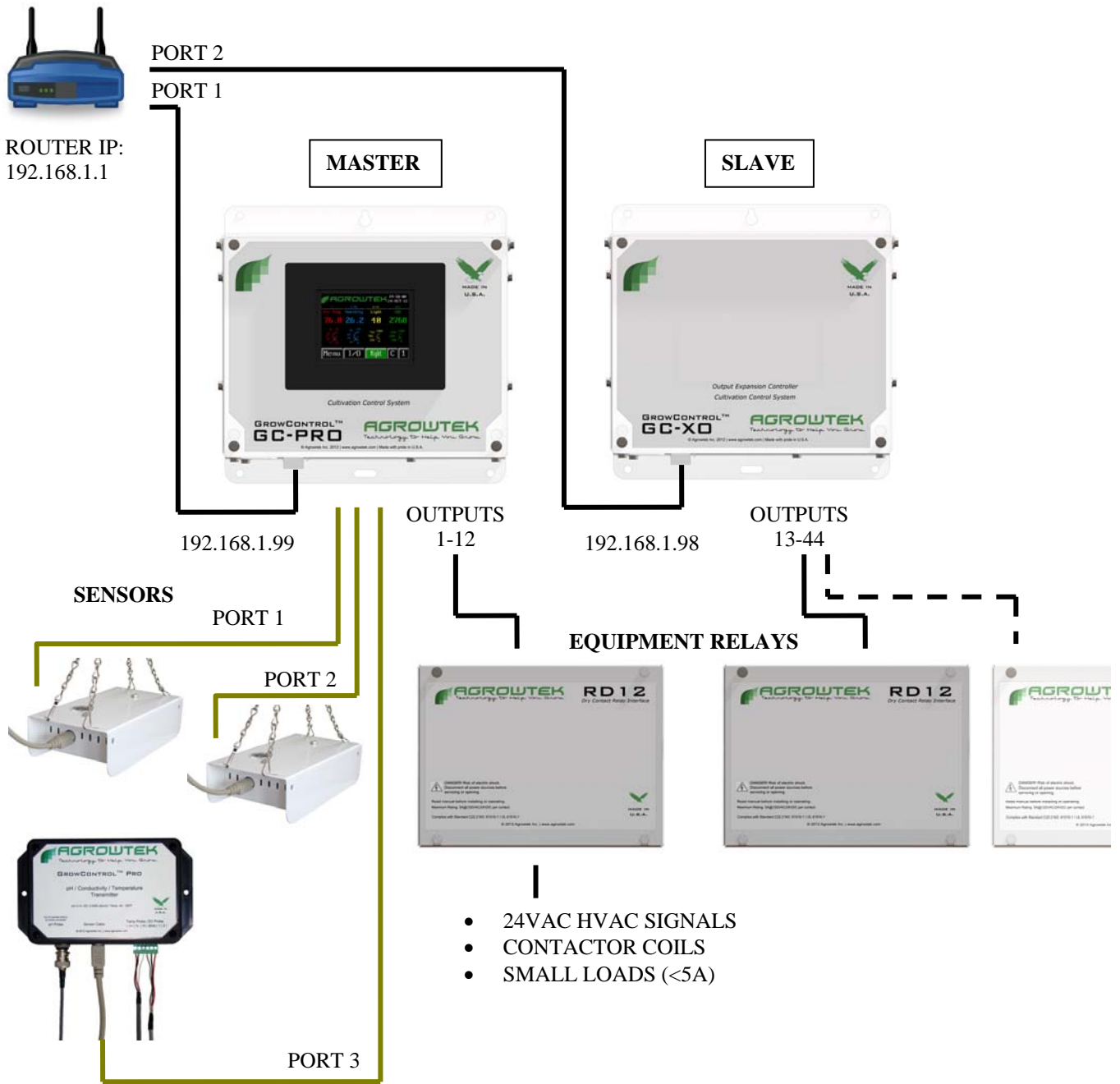

Note: The Default IP address of the XO controller is 192.168.1.98 and responds to a master at 192.168.1.99. The XO's IP may be changed, but changing the master's IP will result in loss of communication with the XO slave. If an alternate master IP is required, please consult Agrowtek.

Typical XO Controller Output Configuration

With GC-Pro as Master

When linked to a GC-Pro controller the output order is as follows:

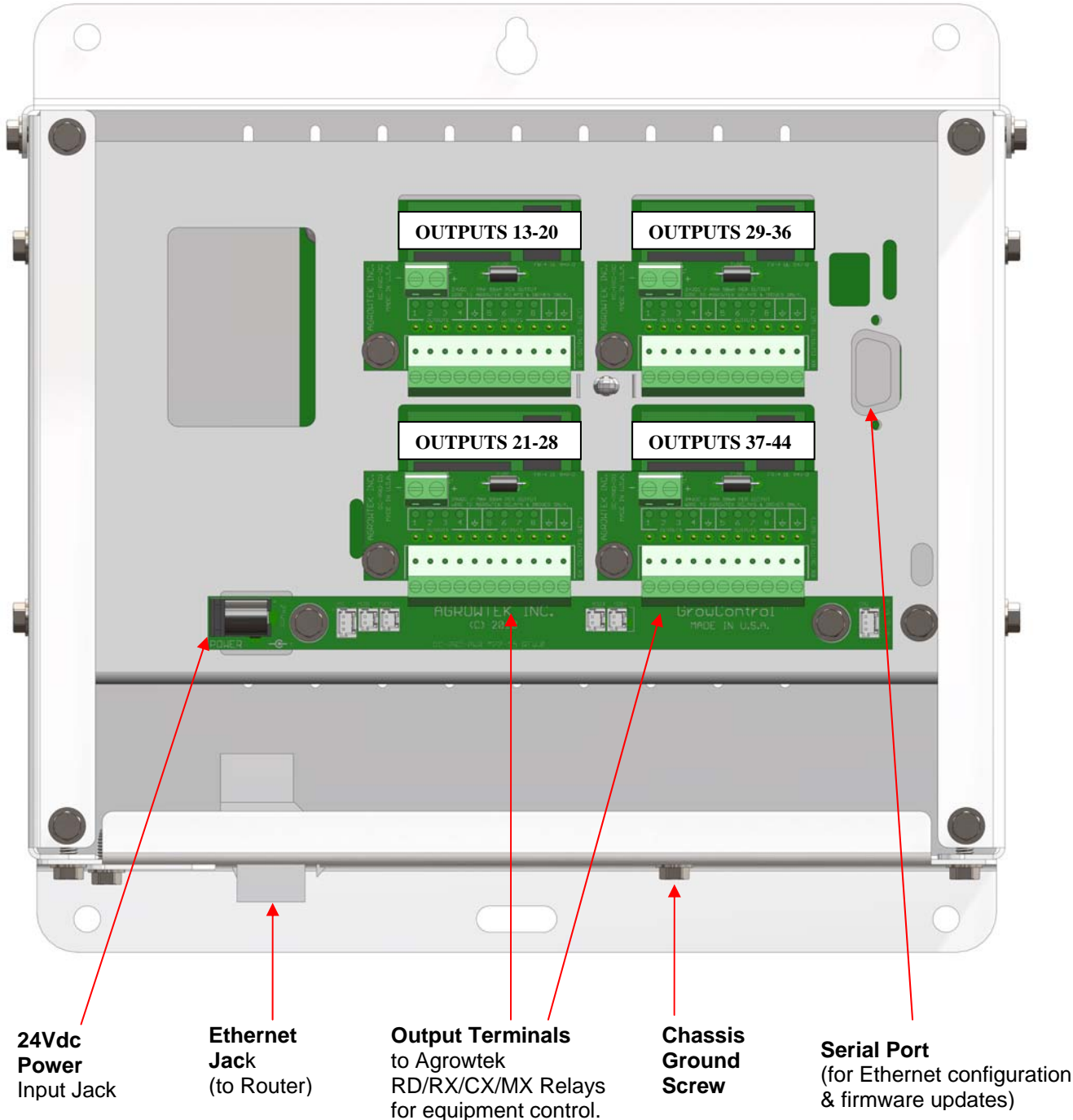

Mounting the Controller

Your controller can be mounted to any wall using the holes in the mounting flanges. The controller must be mounted **upright** on a vertical wall or inside of an electrical enclosure to ensure maximum life. *Agrowtek recommends enclosing the controller in a NEMA type water-proof enclosure with the appropriate clearances around the controller as outlined below for harsh installations.*

Allow adequate space for air convection through the cooling slots in the rear and on the bottom of the enclosure.

Minimum Clearances

Back: None; Mounted to flat surface

Front, Top & Sides: **2 Inches** [50mm]

Make sure the controller, sensors, and other controller accessories are not in a water contact location.

NOTICE
FOR USE IN DRY LOCATIONS ONLY (0-80% RH NON-CONDENSING)
If necessary, mount the controller in a rated enclosure with minimum clearances outlined above.

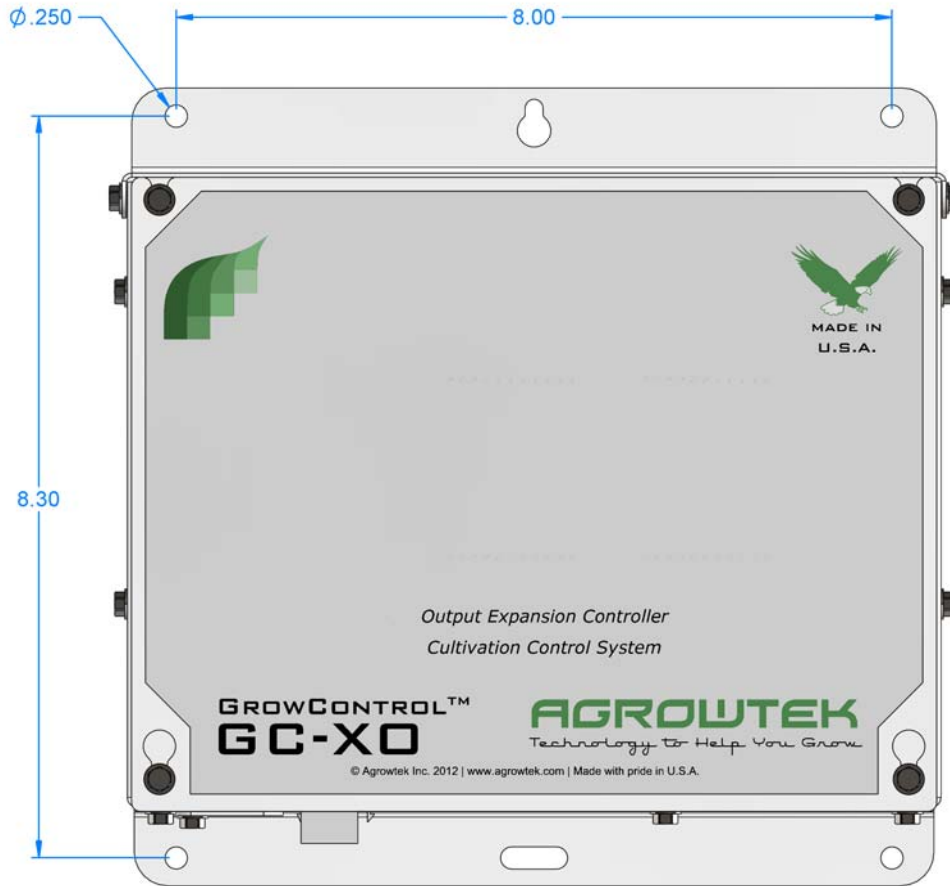

Warranty

Agrowtek Inc. warrants that all manufactured products are, to the best of its knowledge, free of defective material and workmanship and warrants the components for the following period from the date of purchase:

GrowControl™ GC-XO Controllers: 3 Years

This warranty is extended to the original purchaser from the date of receipt.

This warranty does not cover damages from abuse, accidental breakage, or units that have been modified, altered, or installed in a manner other than that which is specified in the installation instructions.

Agrowtek Inc. must be contacted prior to return shipment for a return authorization. No returns will be accepted without a return authorization.

This warranty is applicable only to products that have been properly stored, installed, and maintained per the installation and operation manual and used for their intended purpose. This limited warranty does not cover products installed in or operated under unusual conditions or environments including, but not limited to, high humidity or high temperature conditions.

The products which have been claimed and comply with the aforementioned restrictions shall be replaced or repaired at the sole discretion of the Agrowtek Inc. at no charge.

This warranty is provided in lieu of all other warranty provisions, express or implied. It is including but not limited to any implied warranty of fitness or merchantability for a particular purpose and is limited to the Warranty Period.

In no event or circumstance shall Agrowtek Inc. be liable to any third party or the claimant for damages in excess of the price paid for the product, or for any loss of use, inconvenience, commercial loss, loss of time, lost profits or savings or any other incidental, consequential or special damages arising out of the use of, or inability to use, the product. This disclaimer is made to the fullest extent allowed by law or regulation and is specifically made to specify that the liability of Agrowtek Inc. under this limited warranty, or any claimed extension thereof, shall be to replace or repair the Product or refund the price paid for the Product.

This warranty provides the purchaser with specific rights but the claimant may have other rights which vary by jurisdiction.



AGROWTEK

Technology to Help You Grow!

WWW.AGROWTEK.COM