

SXC Sensor

1. Disconnect cables from the sensor.
2. Remove the hanging bracket (1).
3. Take note the orientation of the light sensor on the cover.
4. Remove the two cover screws (2) and lift off the cover.
5. Locate the CO2 headers on the circuit board.
6. Position and install the CO2 sensor module (3) ensuring the sensor is oriented with the correct pin headers. One header is 4-pins and the other is 5-pins.
7. Re-install the top cover and re-connect cables.
8. Check to ensure the CO2 reading is now working.

Installing the sensor backwards will damage the CO2 module.

Note the light sensor orientation is correct and not backwards.

⚠ Note correct pin alignment.

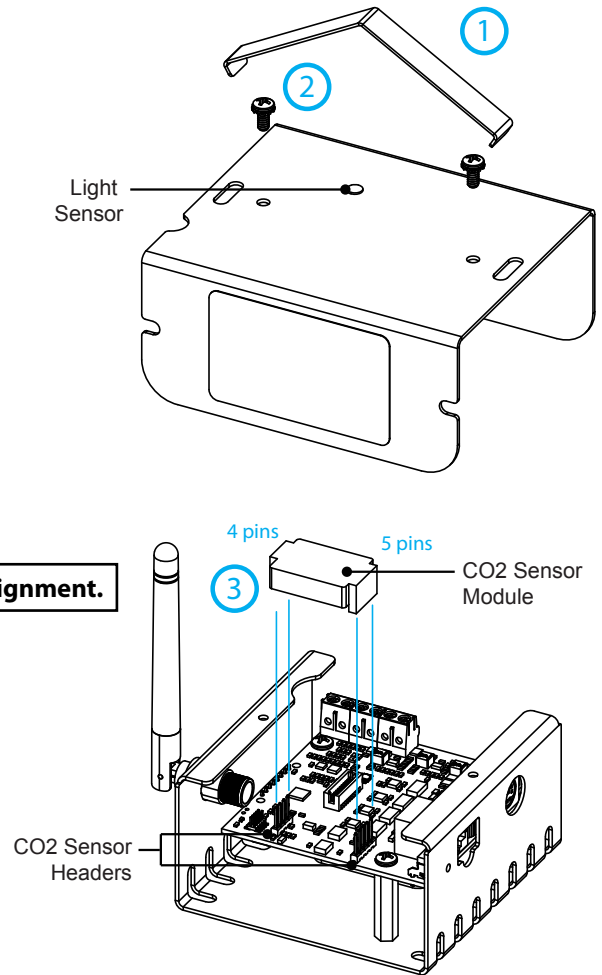

SXE Sensor

1. Disconnect power from the sensor.
2. Remove the rear cover by removing the two screws; use caution not to damage the fan wires.
3. Locate the CO2 headers. One header is 4-pins and the other is 5-pins.
4. Position and install the CO2 sensor module ensuring the sensor is oriented with the correct pin headers.
5. Re-install the rear cover and re-connect power. Check to ensure the CO2 reading is now working.

