

This rugged, motor-actuated PVC ball valve is designed and assembled in the USA for demanding agricultural applications requiring irrigation control and facility water management. The BV100 valve combines high-quality components for reliability that your crop can depend on.

The full-port PVC ball valve is a tru-union type with interchangeable flanges for either NPT threaded pipe, or solvent weld sockets.

High-torque Italian-made actuator from one of the largest actuator manufacturers in the world features an over-sized motor and heavy steel gearing for a long service life. Manual override knob allows operation even in the event of a power failure.

BV100 valves are powered by 24VDC and do not have a minimum operation time. See manual for wiring instructions and requirements.

Valve Approvals: ANSI B1.20.1 ASTM F1970  
 Pressure Rating: 150PSI @ 73°F



Shown with threaded fittings; includes socket weld fittings.

## Features



**True Union Schedule 80 Ball Valve**  
 Thread & Socket Weld Flanges



**Manual Operation Knob**  
 Position Indicator



**4 Second Rotation Time**  
 No Minimum On-Time



**Position Sensing Switches**  
 Monitor Valve Open or Closed



**Stainless Steel Bracket**  
 Made in USA



**Tough Industrial Grade Actuator**  
 IP54, Made in Italy



**Designed & Assembled in USA**



**1-Year Warranty**

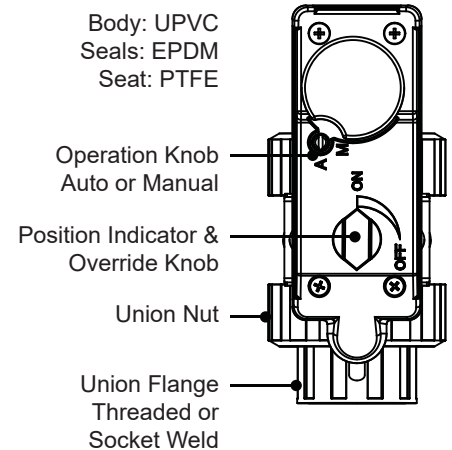
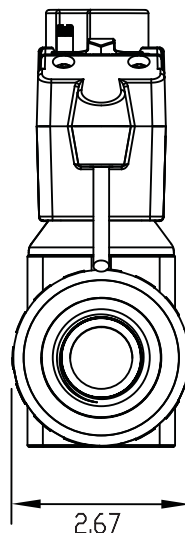
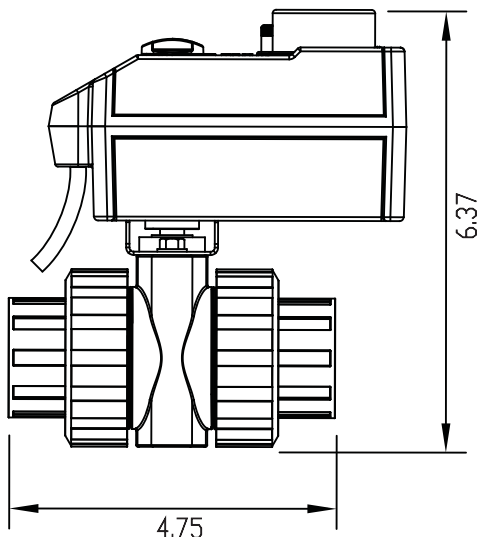

Wetted surfaces less than 0.25% lead content.

# BV100

## Motorized Electric Ball Valve

### Manual Operation

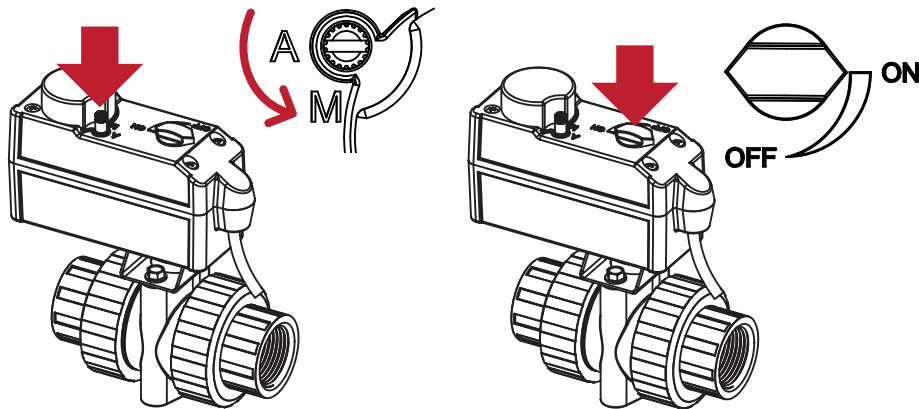

1. Press the operation selector down then rotate to the M position.
2. Rotate the position knob with a 10mm open end wrench.
3. Return the operation selector to the A position for electric operation.

### Schematic

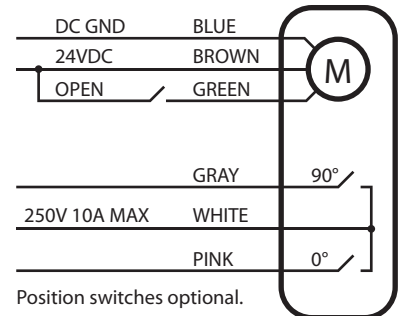

### VX Valve Controllers



VX8i valve controllers connect BV100 ball valves to GrowControl™ GCX series control systems for automated irrigation management. VX8i controllers (revision level F and newer) include a high current power supply and necessary connections to operate the 3-wire ball valve actuator.

### Ordering Options

BV100S

- S: Standard (Normally Closed)
- R: Reversed (Normally Open)
- 100: 1 Inch Port & Flanges

### Optional Accessories



**VX8i**  
Valve Controller