

The RD8i digital dry-contact relay is the most common control interface for the GCX system offering connection to most equipment found in control applications. RD8i relays will control HVAC signals, humidifiers and dehumidifiers, solenoids and irrigation valves, custom relays and high-amp load contactor for lighting, fans, or any other on-off type of component.

Connects instantly to Agrowtek's control systems or intelligent sensors via a GrowNET™ port for advanced automated control functions. GrowNET™ port accepts MODBUS RTU communication for PLC control with the LX2 ModLINK.

LED indicators on the front panel provide status of each relay. Rugged metal enclosure for wall mounting. Durable, high current relays. Conduit knock-outs for easy electrical installation.

Flexible and reliable relay interface suitable for many control applications.



## Features



Eight Independent N.O. Dry Contact Relays with LED Status Indicators



Max 120Vac / 24Vdc / 3.5A per relay



1-Year Warranty



GrowNET™ Digital Communication Port



MODBUS RTU  
for industrial PLC applications



Durable powder-coated steel enclosure



Made in USA

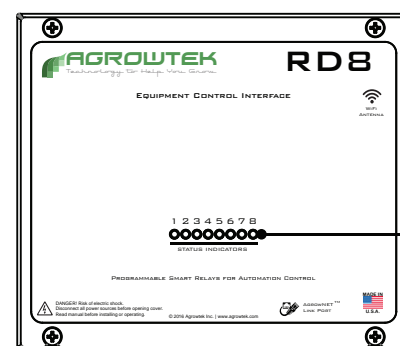
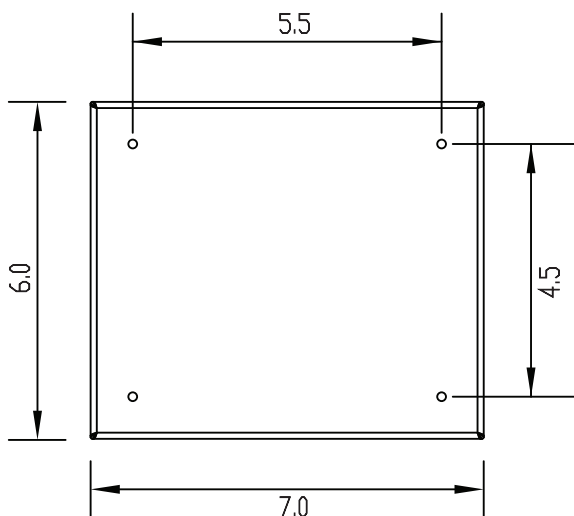

Status LED's

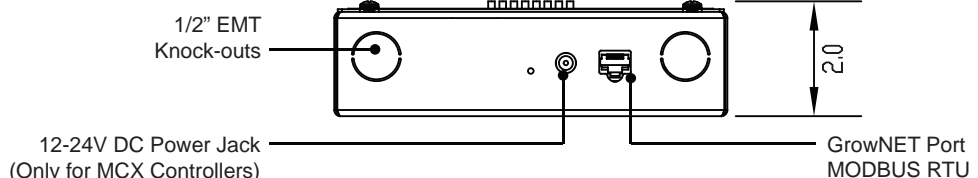

## Applications



**Load Panel Contactor & Relay Control**  
Lighting & load control in buildings & greenhouses



**HVAC Systems**  
24Vac heat, cool, fan, valve & other signals



**Irrigation Solenoid Valves**



**Humidifiers & Dehumidifiers**



**Exhaust & Circulation Fans**



**Custom Equipment**

### GrowControl™ GCX Controller



Connect to GrowControl™ Cultivation Controllers for advanced functions as part of a complete facility control solution. GrowControl™ GCX systems feature intelligent control functions optimized for today's complex growing environments.

### Mini Controller



Connect the RD8i relay directly to Agrowtek's intelligent SXE climate sensors to create a basic environmental control system. Program relay contacts individually for temperature, humidity, or CO2 and cycle timer control. Uses the GrowNET™ ports and a cross-over cable to link the devices together.

### MODBUS



GrowNET™ devices are easy to implement on PLC systems with MODBUS RTU and a LX2 ModLINK interface. Multiple GrowNET™ devices can be connected to an interface with HX8 GrowNET™ hubs.

## Ordering Options

**RD8i**

No Options

## Optional Accessories



**LX1**  
USB  
AgrowLINK™



**LX2**  
RS-485  
ModLINK™



**HX8**  
GrowNET™  
Device Hub